

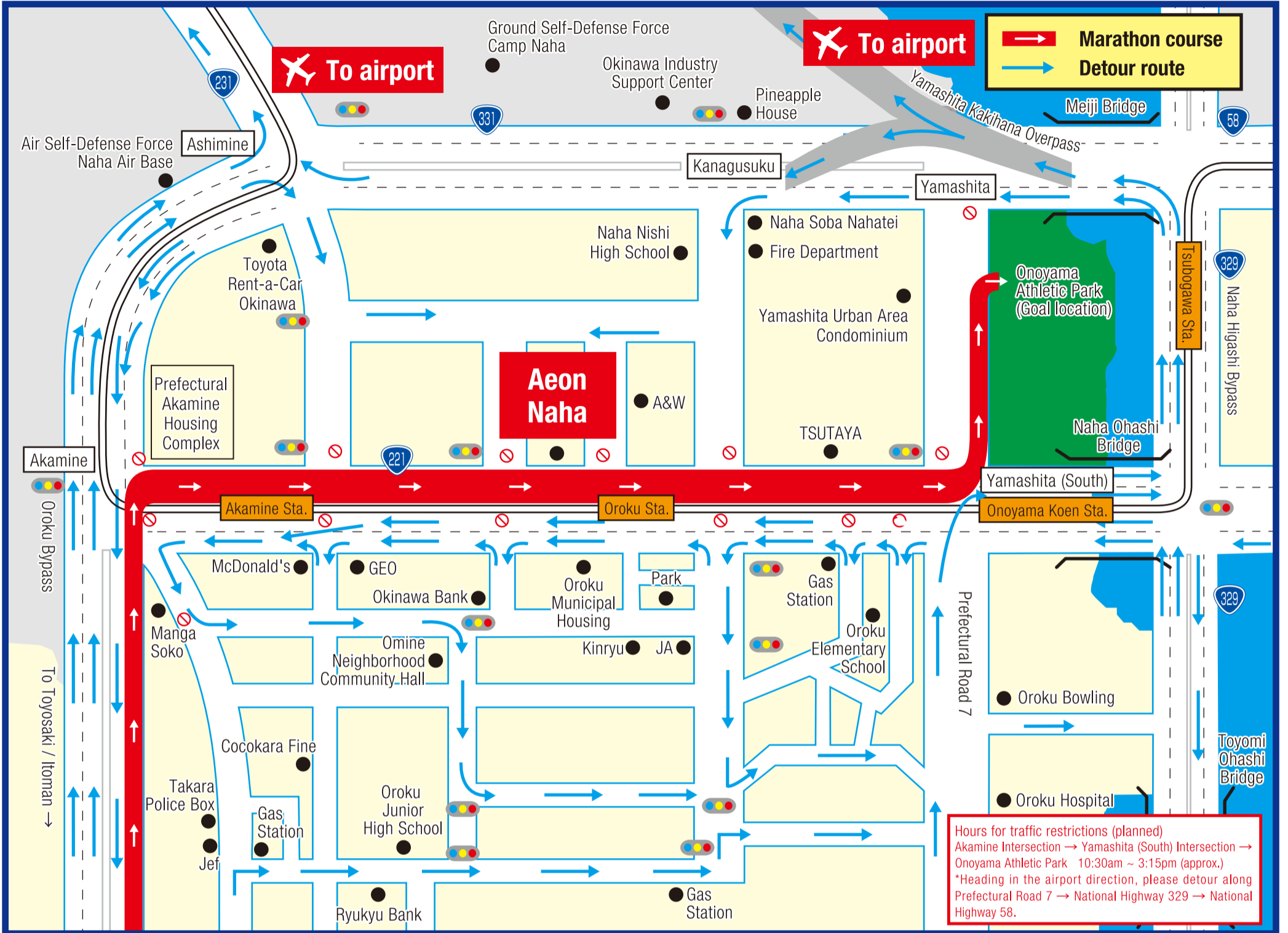

Cooperation request

Detour routes for Naha Airport and Aeon Naha districts

The area from Akamine Intersection on Prefectural Road 221 to Yamashita (South) intersection will completely restricted.



Detour routes for Toyosaki / Nishizaki

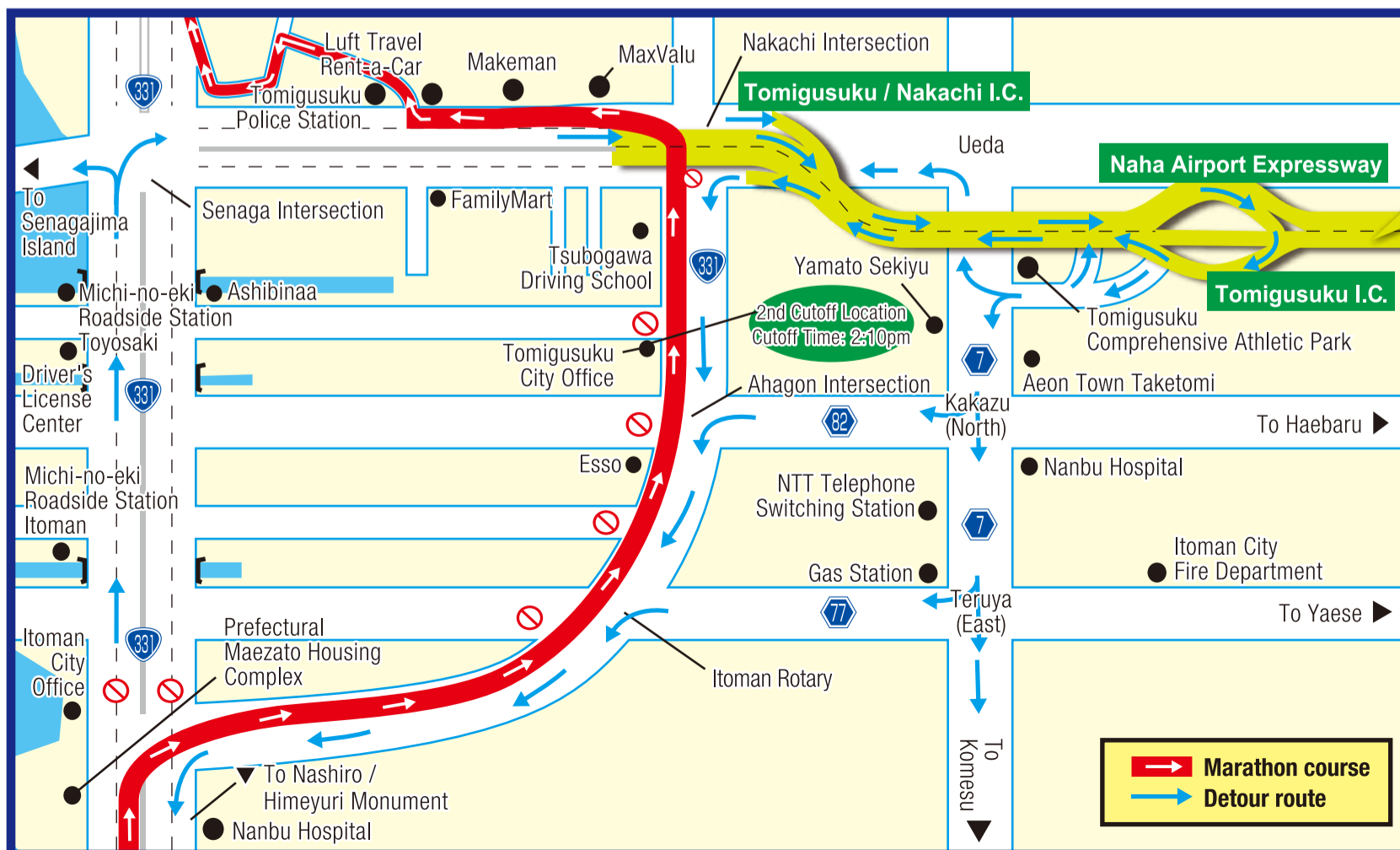

Naha Airport Expressway is a car-only road. Please be aware that motorcycles under 125cc and scooters are not allowed on the expressway.

From Nakachi Intersection, heading towards Ashibinaa / Michi-no-eki Roadside Station
 ◎Head onto the expressway via the Tomigusuku / Nakachi I.C., detour to Tomigusuku I.C., and turn left at Senaga Intersection on the Oroku Bypass.

①Hours for traffic restrictions (planned)
 Itoman Rotary ~ Tomigusuku City Office 10:00am ~ 2:10pm (approx.)
 *Traffic restrictions will be sequentially lifted after the last runner has passed.
 ②Hours for traffic restrictions (planned)
 Ahagon Intersection ~ Oroku Bypass 10:00am ~ 3:15pm (approx.)
 *Traffic restrictions will be sequentially lifted after the last runner has passed.

Detour routes for Nanbu Tokushukai Hospital, Tomigusuku, and Nakachi I.C. area

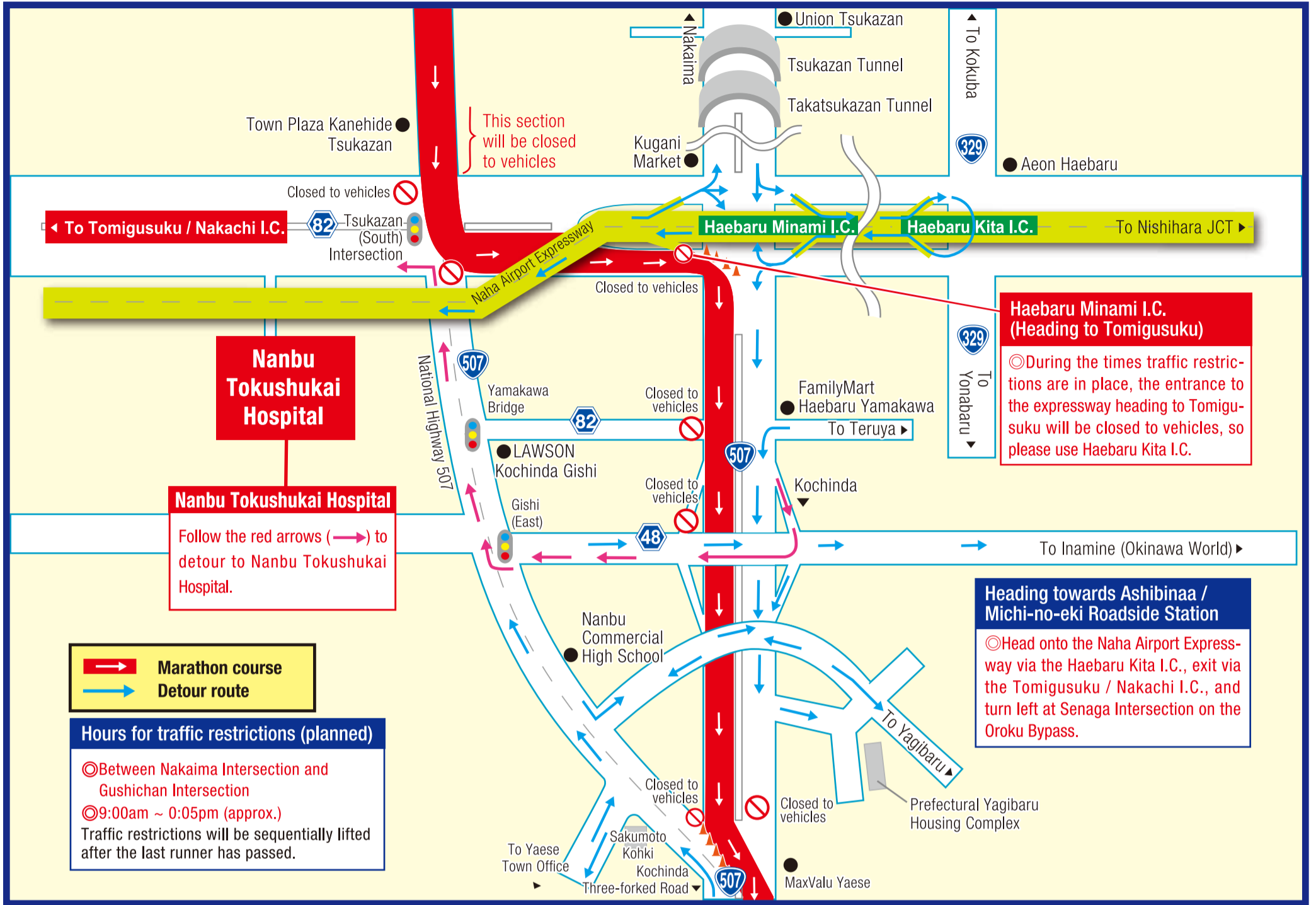

Detour routes from Nakaza Intersection

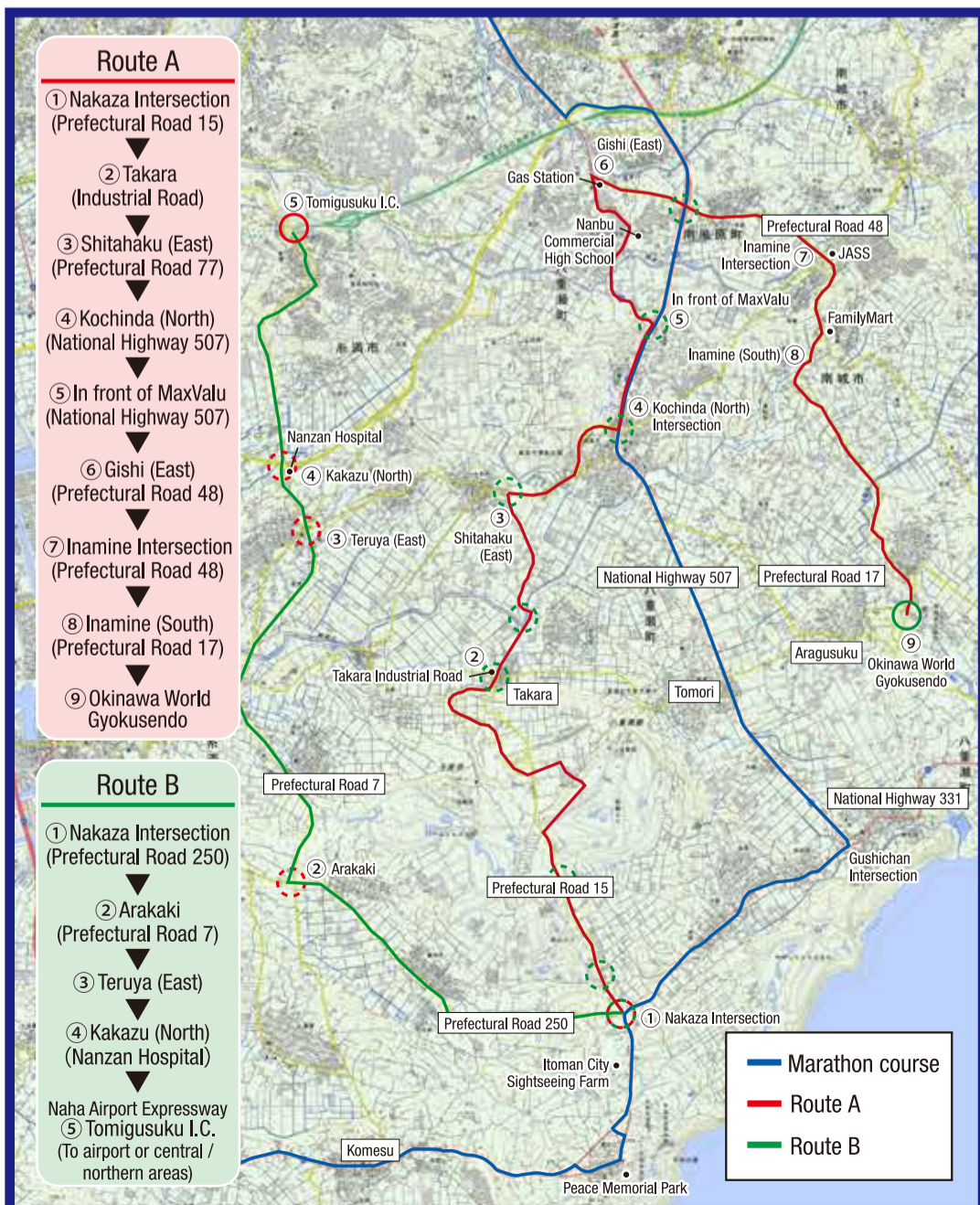

Parking Information

